

BLOCK A ADMIN BLOCK TRUNKING LAYOUT  
SCALE 1:100

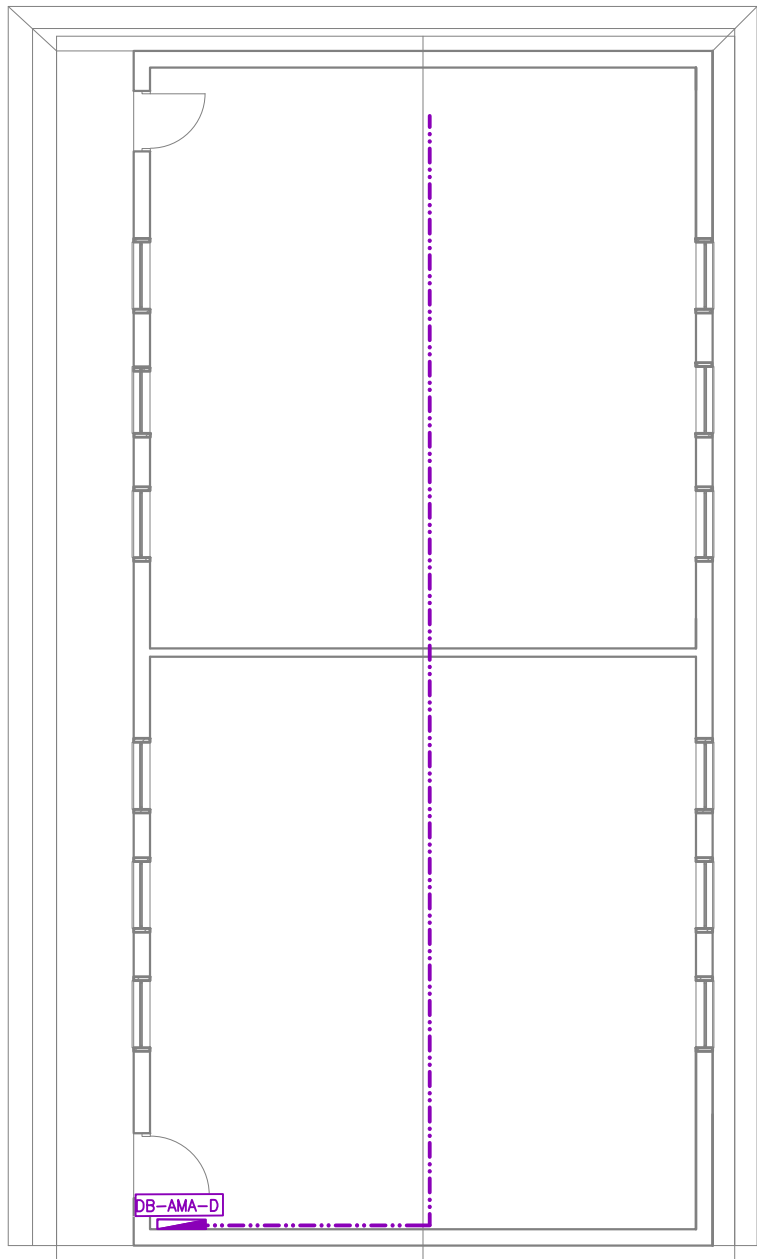

BLOCK D CLASSROOM TRUNKING LAYOUT  
SCALE 1:100

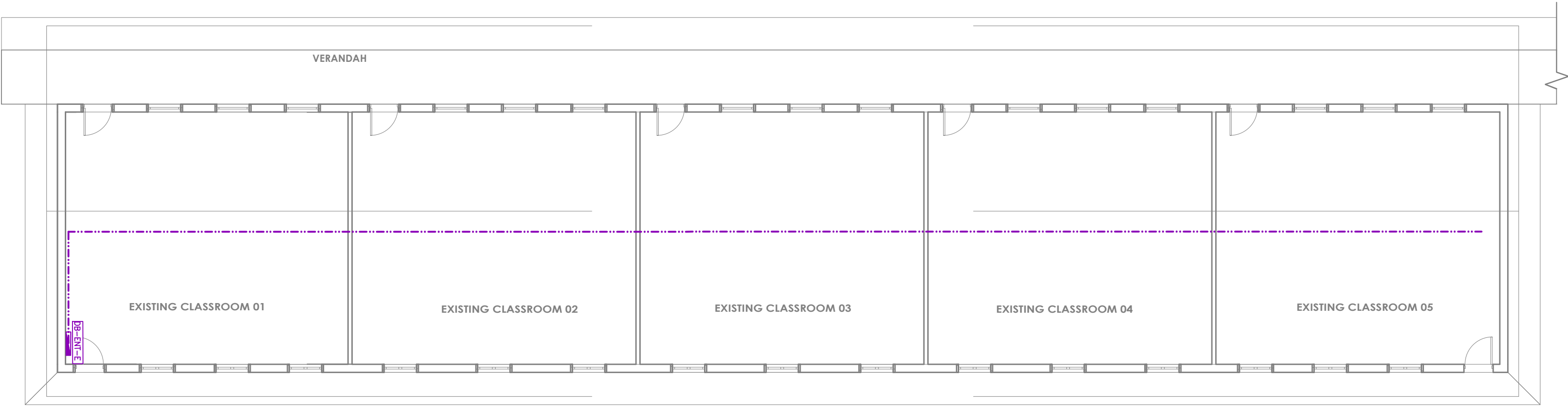

BLOCK B CLASSROOM TRUNKING LAYOUT  
SCALE 1:100

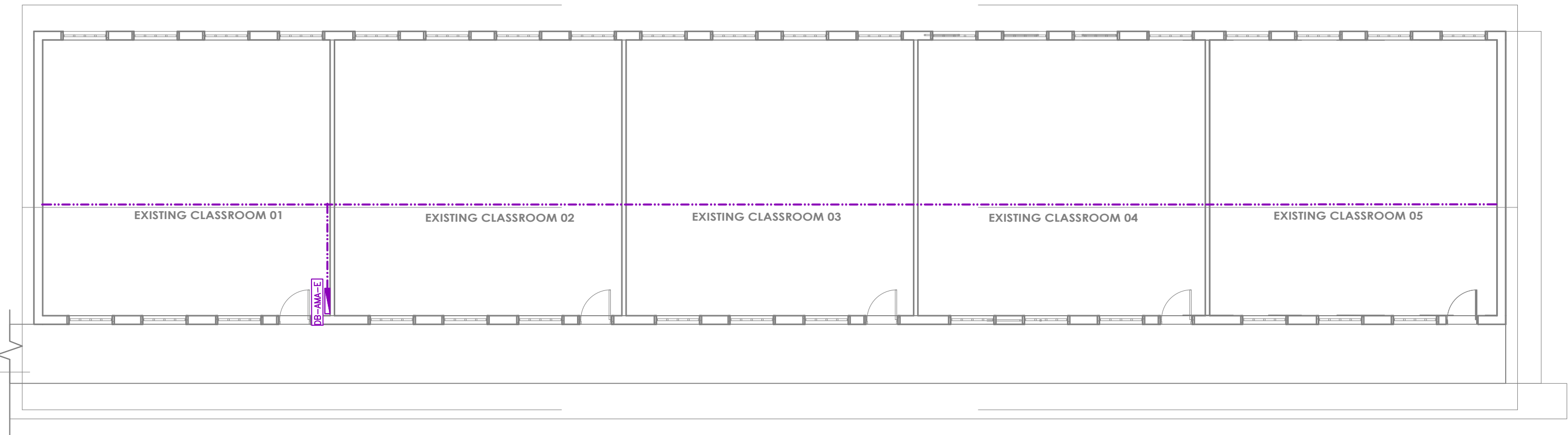

BLOCK E CLASSROOM TRUNKING LAYOUT  
SCALE 1:100

GENERAL NOTES

- ALL DIMENSIONS TO BE CHECKED ON SITE BEFORE WORK COMMENCES.
- CONTRACTOR TO ENSURE THAT THE SCALE AS SHOWN ON THIS DRAWING RELATES TO ACTUAL CONDITIONS.
- TENDERERS SHALL ACQUAINT THEMSELVES WITH THE LOCAL SITE CONDITIONS OF THIS PROJECT, SUCH AS ACCESS TO THE SITE, SIZE AND TYPE OF SITE, STORAGE SPACE, LOADING AND UNLOADING FACILITIES, SCAFFOLDING, TACKLES AND TOOLS NEEDED FOR THE ERECTION OF THE INSTALLATION, ADDITIONAL CLAUSES BY THE ELECTRICAL SUBCONTRACTOR, WHICH MAY ARISE FROM IGNORANCE OF THE SITE CONDITIONS WILL NOT BE CONSIDERED AND TENDERERS ARE ADVISED TO VISIT AND INSPECT THE SITE BEFORE SUBMITTING THEIR TENDER PRICE.
- ANY CONTRADICTION OF THESE PLANS MUST BE BROUGHT TO THE ATTENTION OF THE ARCHITECTURAL STUDIO.WORK FINISHES TO COMPLY WITH THE SPECIFICATIONS.
- REFER TO DETAILS AND NOTES ON THIS DRAWING WHERE SHOWN.
- WALL SOCKETS TO BE Ø300mm AFFL UNLESS OTHERWISE SPECIFIED.
- PLEASE READ THIS DRAWING IN CONJUNCTION WITH THE OTHER SERVICES DRAWING PRIOR TO THE INSTALLATION OF ANY WIRE MESH BASKETS OR PB000 TRUNKING INCLUDING POWER AND LIGHTING.
- FINAL LEVELS OF THE ABOVE SERVICES WILL BE DETERMINED BY THE LEVEL OF THE AIR CONDITIONING DUCT WORK.
- NO POWER SKIRTING TO BE FIXED TO ANY DESKS, DESKS ARE PROVIDED WITH CABLE CHANNEL UNDERNEATH TOP. CONTRACTOR WILL BE RESPONSIBLE FOR ANY DAMAGE TO DESKING.
- ALL LOOSE CABLING TO BE HELD TOGETHER WITH BLACK PVC SPIRAL CORDS.

POWER LEGEND

	NEW 16amp STANDARD SOCKET 3 PIN SWITCH SOCKET OUTLETS BEARING THE S.A.B.S. MARK. 16AMP 3-PIN NORMAL SSO's TO BE WIRED WITH 2.5mm P.V.C WIRE. 2.5mm B.C.E.W. IN POWERSKIRTING. 20mm P.V.C CONDUIT IS TO BE INSTALLED TO ALL POINTS IN PARTITIONING. 20AMP S.P. 5KA CB IN DISTRIBUTION BOARD FOR PROTECTION. 6 X SSO's PER CIRCUIT.
	NEW 16amp STANDARD SOCKET 2 PIN SWITCH SOCKET OUTLETS BEARING THE S.A.B.S. MARK. TO BE WIRED WITH 2.5mm P.V.C WIRE. 2.5mm B.C.E.W. IN POWERSKIRTING. 20mm P.V.C CONDUIT IS TO BE INSTALLED TO ALL POINTS IN PARTITIONING. 20AMP S.P. 5KA CB IN DISTRIBUTION BOARD FOR PROTECTION. 6 X SSO's PER CIRCUIT.
	NEW DOUBLE 16amp STANDARD SOCKET 3 PIN SWITCH SOCKET OUTLETS BEARING THE S.A.B.S. MARK. 16AMP 3-PIN NORMAL SSO's TO BE WIRED WITH 2.5mm P.V.C WIRE. 2.5mm B.C.E.W. IN POWERSKIRTING. 20mm P.V.C CONDUIT IS TO BE INSTALLED TO ALL POINTS IN PARTITIONING. 20AMP S.P. 5KA CB IN DISTRIBUTION BOARD FOR PROTECTION. 6 X SSO's PER CIRCUIT.
	DATA POINT - 100 x 100 DRAW BOX IN WALL, C/W BLANK PLATE OR IN DATA SECTION OF SKIRTING C/W BLANK COVER PLATE
	TELEPHONE POINT - 100 x 100 DRAW BOX IN WALL, C/W BLANK PLATE OR IN DATA SECTION OF SKIRTING C/W BLANK COVER PLATE
	DOUBLE POLE ISOLATOR
	TRIPLE POLE ISOLATOR
	3PH INDUSTRIAL SOCKET
	PB000 TRUNKING FOR POWER AND LIGHTING
	DISTRIBUTION BOARD
	1x300mm WIDE GALVANISED CABLE BASKET IN CEILING VOID FOR DATA SERVICES.

B	05.07.2023	T.T	CHANGED EMIS NUMBER	LL	LL.
A	03.07.2023	T.T	ISSUED FOR INFORMATION	LL	LL.
REV	DATE	BY	DESCRIPTION	CHK	APD

DRAWING STATUS:

FOR INFORMATION

FUNDER:



IMPLEMENTING AGENT:



PRINCIPAL AGENT:



ARCHITECT:



ENGINEER:



6, Scherwitz Road | Beria | East London  
Tel: +27 43 722 3353 Fax: +27 86 554 6496  
info@karosolutions.co.za

PROJECT:

AMABUYE SECONDARY SCHOOL,  
DUBE TRIBAL AUTHORITY,  
ESIKHAWINI, 3887, KWAZULU  
NATAL.  
EMIS No: 500101306

TITLE:

BLOCK A, B, C, & E CLASSROOMS  
TRUNKING LAYOUT

SCALE @ A1:	1:100	CHECKED:	LL	APPROVED:	LL
CAD FILE:	KS130-T01	DESIGN/DRAWN:	T.T-T.T	DATE:	03.07.2023
PROJECT No:	KS130	DRAWING No:	KS130-T01	REV:	B